

**NOTICE!!**

**These documents have been scanned!**

**Do not place un-scanned documents beneath this notice!**

**Do not remove this notice from this file!**

GPO Jacket No. 560-102  
Print Order 61540  
Rise Business Services, LLC  
Job=AZ15 7/11/2019



Box Number= AZ15154



Claim Begin-End: AMC452230-AMC452234

**1 Initial Receipt**



AZ15154-23

AMC451761-AMC452292

**United States Department of the Interior**  
**Bureau of Land Management**  
 DIV OF LANDS, MINRLS & ENERGY  
 ONE N CENTRAL AVE  
 PHOENIX, AZ 85004 -4427  
 Phone: 602-417-9200

Receipt

No: 4257598

<b>Transaction #:</b> 4373163	
<b>Date of Transaction:</b> 09/06/2018	
CUSTOMER:	
USA GOLD MINING LLC 27W438 KNOCH KNOLLS RD NAPERVILLE,IL 60565-5455 US	

**ENTERED**  
 SEP 17 2018  
 BY: *Ram*

LINE #	QTY	DESCRIPTION	REMARKS	UNIT PRICE	TOTAL
1	5.00	LOCATABLE MINERALS / MINING CLAIMS-NEW,UNADJUD, ONE OR MORE AUTH NOS / NEW MINING CLAIM PROCESSING FEE CASES: AMC452230/\$20.00, AMC452231/\$20.00, AMC452232/\$20.00, AMC452233/\$20.00, AMC452234/\$20.00		- n/a -	100.00
2	5.00	LOCATABLE MINERALS / MINING CLAIMS-NEW,UNADJUD, ONE OR MORE AUTH NOS / NEW MINING CLAIMS LOCATION FEE CASES: AMC452230/\$37.00, AMC452231/\$37.00, AMC452232/\$37.00, AMC452233/\$37.00, AMC452234/\$37.00		- n/a -	185.00
3	5.00	LOCATABLE MINERALS / MINING CLAIMS-NEW,UNADJUD, ONE OR MORE AUTH NOS / NEW MINING CLAIMS MAINTENANCE FEE CASES: AMC452230/\$155.00, AMC452231/\$155.00, AMC452232/\$155.00, AMC452233/\$155.00, AMC452234/\$155.00		- n/a -	775.00
4	5.00	LOCATABLE MINERALS / MINING CLAIMS-NOT NEW-UNADJUD,ONE AUTH NO. ONLY / MINING CLAIM MONEY RECEIVED CASES: AMC452230/\$155.00, AMC452231/\$155.00, AMC452232/\$155.00, AMC452233/\$155.00, AMC452234/\$155.00	2019 MAINT/5	- n/a -	775.00

**TOTAL: \$1,835.00**

PAYMENT INFORMATION			
1	AMOUNT:	1835.00	POSTMARKED: N/A
	TYPE:	CHECK	RECEIVED: 09/06/2018
	CHECK NO:	1045	
	NAME:	USA GOLD MINING LLC 27W438 KNOCH KNOLLS RD NAPERVILLE IL 60565-5455 US	

REMARKS
---------

This receipt was generated by the automated BLM Collections and Billing System and is a paper representation of a portion of the official electronic record contained therein.

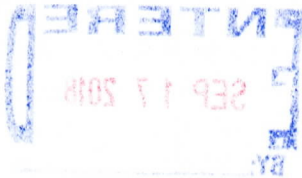

**NOTICE!!**

**These documents have been scanned!**

**Do not place un-scanned documents beneath this notice!**

**Do not remove this notice from this file!**

GPO Jacket No. 560-102  
Print Order 61540  
Rise Business Services, LLC  
Job=AZ15 7/11/2019



Box Number= AZ15154



Claim Begin-End: AMC452230-AMC452234

**2 Correspondence**



AZ15154-23

AMC451761-AMC452292

**NO  
DOCUMENTS  
FOUND**

NO DOCUMENTS FOUND  
NO DOCUMENTS FOUND

**NOTICE!!**

**These documents have been scanned!**

**Do not place un-scanned documents beneath this notice!**

**Do not remove this notice from this file!**

GPO Jacket No. 560-102  
Print Order 61540  
Rise Business Services, LLC  
Job=AZ15 7/11/2019



Box Number= AZ15154



Claim Begin-End: AMC452230-AMC452234

**3 Transfers**



AZ15154-23

AMC451761-AMC452292

**NO  
DOCUMENTS  
FOUND**

NO DOCUMENTS FOUND  
NO DOCUMENTS FOUND

**NOTICE!!**

**These documents have been scanned!**

**Do not place un-scanned documents beneath this notice!**

**Do not remove this notice from this file!**

GPO Jacket No. 560-102  
Print Order 61540  
Rise Business Services, LLC  
Job=AZ15 7/11/2019



Box Number= AZ15154



Claim Begin-End: AMC452230-AMC452234

**4 Annual Filings**



AZ15154-23

AMC451761-AMC452292



**NO  
DOCUMENTS  
FOUND**

NO DOCUMENTS FOUND  
NO DOCUMENTS FOUND

**NOTICE!!**

**These documents have been scanned!**

**Do not place un-scanned documents beneath this notice!**

**Do not remove this notice from this file!**

GPO Jacket No. 560-102  
Print Order 61540  
Rise Business Services, LLC  
Job=AZ15 7/11/2019



Box Number= AZ15154



Claim Begin-End: AMC452230-AMC452234

**5 Miscellaneous**



AZ15154-23

AMC451761-AMC452292

**NO  
DOCUMENTS  
FOUND**

NO DOCUMENTS FOUND  
NO DOCUMENTS FOUND

**NOTICE!!**

**These documents have been scanned!**

**Do not place un-scanned documents beneath this notice!**

**Do not remove this notice from this file!**

GPO Jacket No. 560-102  
Print Order 61540  
Rise Business Services, LLC  
Job=AZ15 7/11/2019



Box Number= AZ15154



Claim Begin-End: AMC452230-AMC452234

**6 Location Notices-Amendments and Supporting Documents**



AZ15154-23

AMC451761-AMC452292

# MINING CLAIM STATUS REPORT

Data Entered: 9/17/18 Rum

MTP Checked By: DER

GEO Checked By: DER

LEAD SERIAL NUMBER: AMC 452230 thru AMC 452234

### NUMBER OF CLAIMS & TYPE:

LODE  
 5 PLACER  
 ASSOCIATION PLACER  
 MILL SITE  
 TUNNEL SITE

### CHARGES:

Processing Fee @ \$20 = \$ 100<sup>00</sup>  
 Location Fee @ \$37 = \$ 185<sup>00</sup>  
 Maintenance Fee @ \$155 = \$ 775<sup>00</sup>  
 Add'l Maint Fee for Assoc Placer = \$ \_\_\_\_\_  
**SUBTOTAL** \$ \_\_\_\_\_  
2019 MAINT Other Fees \$ 775<sup>00</sup>  
 Other Fees \$ \_\_\_\_\_  
**TOTAL** \$ 1835<sup>00</sup>

TOTAL ACREAGE: 20 Per Claim  
(Placer Only)

NUMBER OF LOCATORS: 1

DOCUMENTS RECEIVED VIA: Over-the-Counter [ ] Mail [ ] **TIMELY FILED:** Yes [ ] No [ ]

LEGAL DESCRIPTION:

T	<u>11N</u>	R	<u>1E</u>	SEC	<u>34 4 3</u>
T	<u>10N</u>	R	<u>1E</u>	SEC	<u>4 3</u>
T		R		SEC	
T		R		SEC	
T		R		SEC	

BLM [ ] FOREST SERVICE  WILDERNESS AREA [ ] SUBJ TO PL 359: Yes [ ] No [ ]

SPLIT ESTATE: N/A [ ] SX [ ] PX [ ] OTHER [ ]  
SRHA [ ] Was proper Notice filed if located on SRHA Land? Yes [ ] No [ ]

### RECONVEYED MINERALS ON BLM LAND REQUIRE OPENING ORDER FROM 1944 TO 1993:

Open to Entry On \_\_\_\_\_ N/A [ ]

COMMENTS/STATUS: VOID [ ] PARTIALLY VOID [ ] PVT MINERALS [ ] WITHDRAWN LANDS [ ]  
OTHER [ ] \_\_\_\_\_

[ ] Claimant acknowledges that portions of the following claim(s) site(s) may be void or voidable.

Printed Name of Claimant \_\_\_\_\_ Signature of Claimant \_\_\_\_\_

\*\*\*\*\*FINAL ADJUDICATION\*\*\*\*\*

DATE \_\_\_\_\_ INITIALS \_\_\_\_\_



\* See below

**LOCATION NOTICE FOR PLACER MINING CLAIM**

Amendment BLM Serial # \_\_\_\_\_

NOTICE IS HEREBY GIVEN that the IRMO-P5  
\_\_\_\_\_ placer mining claim has been located by  
USA GOLD MINING, LLC whose current mailing  
\* address is 27W438 Knoch Knolls Rd. Naperville, IL 60565

RECEIVED  
BLM AZ STATE OFFICE  
2018 SEP -6 P 3:09  
PHOENIX, ARIZONA  
BLM  
Date  
Stamp

The general course of this claim is East-West and it is situated in Yavapai  
County, Arizona. This claim is 1320 feet in length and 600 feet in width.

20 Total Claim Acreage. This claim runs from the location monument on which this location notice is  
posted at the SW corner of the claim approximately 1320 feet in a EAST direction to the  
EAST end line and 0 feet in a NORTH direction to the WEST end line. This claim is  
marked by four monuments, one at each corner of the claim.

The location monument on which this notice is posted is situated within Section 34, Township  
11N, Range 1E, Gila Salt River Base and Meridian, Arizona. This claim encompasses  
portions of the following legal subdivision(s) if located by legal subdivision or the following quarter section(s),  
section(s), Township(s) and Range(s) SW1/4, SW1/4 SECTION 34 T11N R1E  
\_\_\_\_\_, Gila Salt River Base and Meridian, Arizona.

AN0452230

The locality of this claim with reference to some natural object or permanent monument and additional information  
(if any) concerning its locality are as follows: Approximately 200 feet east of the SW corner  
of Section 34

\_\_\_\_\_ The above information is shown on the attached map.

DATED AND POSTED on the ground this 25<sup>th</sup> day of August, 2018.

LOCATOR(s)  AGENT

Print Name(s) John Lebamoff

Signature(s) \_\_\_\_\_

Form MCF102  
Revised July 2014

# IRMO-P Claim Location Map

Unsurveyed  
Section  
Projections  
T11/10N R1E  
Poland Creek  
as provided by

General Land Office  
Master Title Plat &  
Earth Point 2018  
35

Approximate  
Wilderness  
Boundary  
as provided  
by the BLM  
& USFS

Approximate IRMO-P  
Claim Location

Approximate  
Location Post

Public Land Survey System  
subdivision for 20 acres  
is 1320ft x 660ft.

(BLACK CANYON CITY)  
SCALE 1:24000

Copyright (C) 2009 MyTopo  
Printed Sun Aug 20, 2017

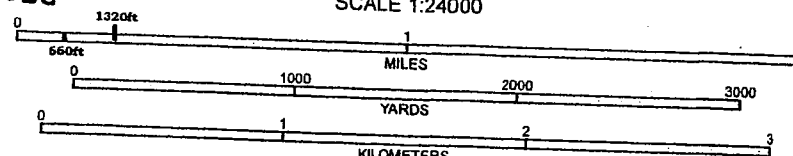

CONTOUR INTERVAL 40 FEET  
NATIONAL GEODETIC VERTICAL DATUM 1988



RECEIVED  
AZ STATE OFFICE  
2018 SEP - 6 P 3:10  
PHOENIX, ARIZONA

ANC 452230

(CROWN KING)

(JOES HILL)

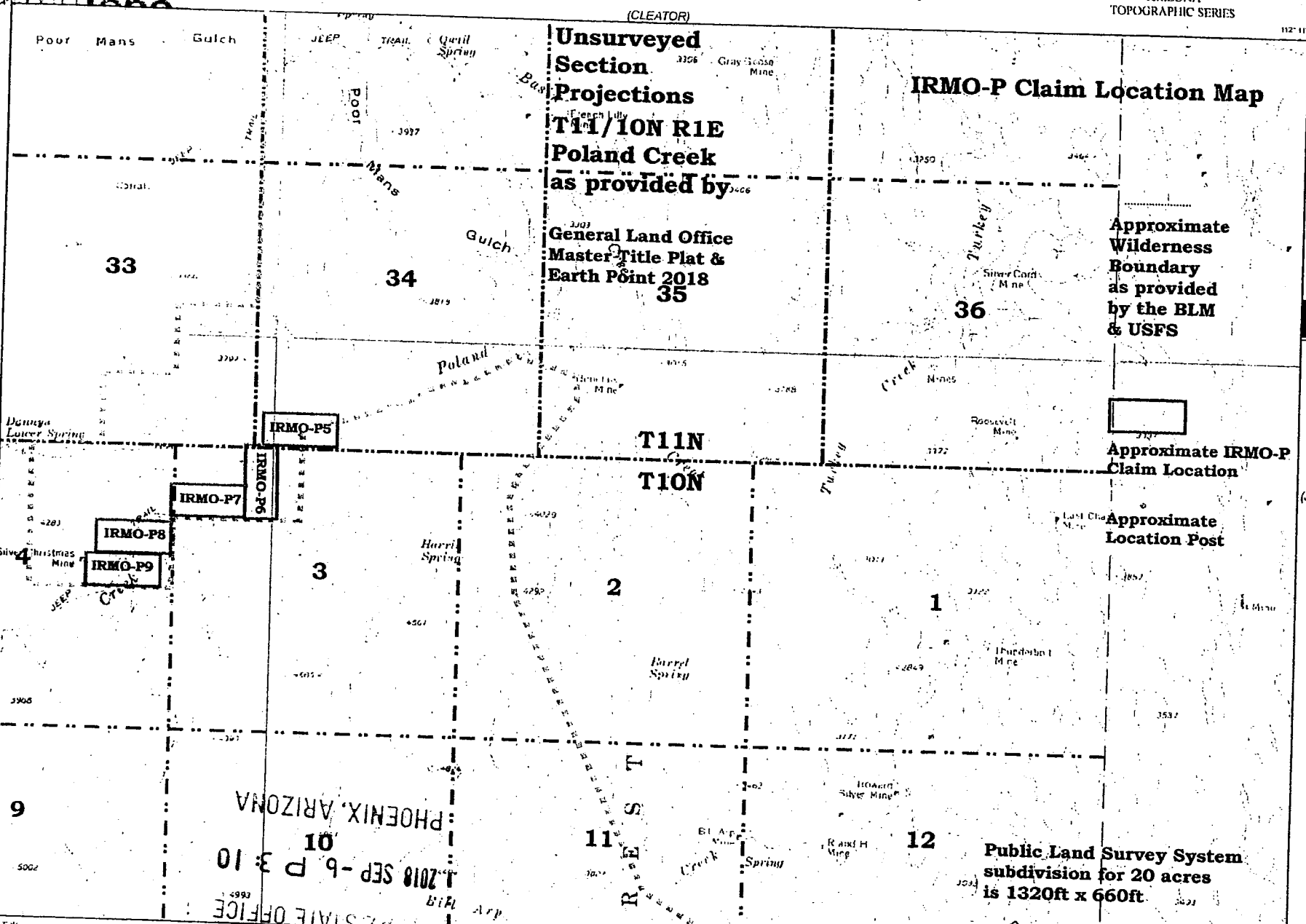

... Projection  
GS 1 24 000 Maps  
in (NAD83)  
North American 1927 move the projection lines 4M N and 66M



\* See below

**LOCATION NOTICE FOR PLACER MINING CLAIM**

Amendment BLM Serial # \_\_\_\_\_

NOTICE IS HEREBY GIVEN that the IRMO-P6  
\_\_\_\_\_ placer mining claim has been located by

\* USA GOLD MINING, LLC whose current mailing  
address is 27W438 Knoch Knolls Rd, Naperville, IL 60565

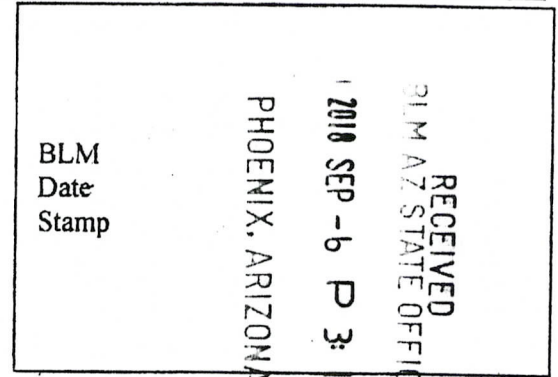

The general course of this claim is North-South and it is situated in Yavapai  
County, Arizona. This claim is 1320 feet in length and 600 feet in width.

20 Total Claim Acreage. This claim runs from the location monument on which this location notice is  
posted at the North-Center corner of the claim approximately 1320 feet in a South direction to the  
South end line and 0 feet in a NORTH direction to the North end line. This claim is  
marked by four monuments, one at each corner of the claim.

The location monument on which this notice is posted is situated within Section 34, Township  
11N, Range 1E, Gila Salt River Base and Meridian, Arizona. This claim encompasses  
portions of the following legal subdivision(s) if located by legal subdivision or the following quarter section(s),  
section(s), Township(s) and Range(s) SW1/4, SW1/4 SECTION 34 T11N R1E and  
extends into Section 3 T10N R1E NW1/4, NW1/4, Gila Salt River Base and Meridian, Arizona.

The locality of this claim with reference to some natural object or permanent monument and additional information  
(if any) concerning its locality are as follows: Approximately 200 feet east of the SW corner  
of Section 34 T11N R1E is the location post.

\_\_\_\_\_ The above information is shown on the attached map.

DATED AND POSTED on the ground this 25<sup>th</sup> day of August, 2018.

LOCATOR(s)  AGENT

Print Name(s) John Lebamoff

Signature(s) \_\_\_\_\_

Form MCF102  
Revised July 2014

AMC452231



(CLEATOR)

112° 11' 17.25" W  
34° 18' 00.00" N

Unsurveyed  
Section

Projections  
T11/10N R1E  
Poland Creek

as provided by

General Land Office  
Master Title Plat &  
Earth Point 2018

IRMO-P Claim Location Map

RECEIVED  
BLM AZ STATE OFFICE

2018 SEP - 5 P 3: 10

PHOENIX, ARIZONA

Approximate  
Wilderness  
Boundary  
as provided  
by the BLM  
& USFS

Approximate IRMO-P  
Claim Location

Approximate  
Location Post

Public Land Survey System  
subdivision for 20 acres  
is 1320ft x 660ft

ANCH 52231

Copyright (C) 2009 MyTopo

(50)

BUMBLE BEE, AZ  
1969

112° 16' 03.42" W  
34° 16' 00.00" N

(CROWN KING)

(JOES HILL)

034° 13' 12.47" W  
112° 16' 03.42" W

034° 13' 12.47" W  
112° 11' 17.25" W

Declination



(BLACK CANYON CITY)  
SCALE 1:24000

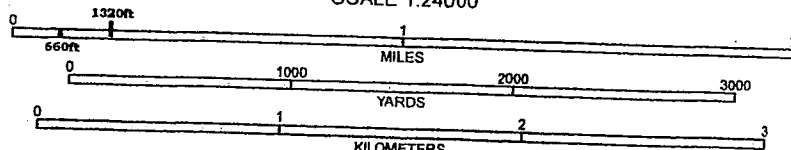

CONTOUR INTERVAL 40 FEET  
NATIONAL GEODETIC VERTICAL DATUM 1929

ivigator  
24,000 Maps  
AD83)  
American 1927 move the projection lines 4M N and 6GM

\* See below

**LOCATION NOTICE FOR PLACER MINING CLAIM**

Amendment BLM Serial # \_\_\_\_\_

NOTICE IS HEREBY GIVEN that the IRMO-P7

\_\_\_\_\_ placer mining claim has been located by

USA GOLD MINING, LLC whose current mailing

\* address is 27W438 Knoch Knolls Rd, Naperville, IL 60565

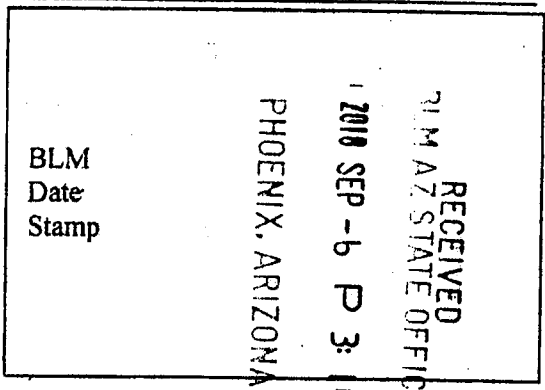

The general course of this claim is East-West and it is situated in Yavapai

County, Arizona. This claim is 1320 feet in length and 600 feet in width.

20 Total Claim Acreage. This claim runs from the location monument on which this location notice is posted at the NE corner of the claim approximately 1320 feet in a EAST direction to the EAST end line and 0 feet in a NORTH direction to the WEST end line. This claim is marked by four monuments, one at each corner of the claim.

The location monument on which this notice is posted is situated within Section 3, Township 10N, Range 1E, Gila Salt River Base and Meridian, Arizona. This claim encompasses portions of the following legal subdivision(s) if located by legal subdivision or the following quarter section(s), section(s), Township(s) and Range(s) NW1/4, NW1/4 SECTION 3 T10N R1E

\_\_\_\_\_, Gila Salt River Base and Meridian, Arizona.

The locality of this claim with reference to some natural object or permanent monument and additional information (if any) concerning its locality are as follows: Approximately 915 feet south and 100 feet west of the SW corner of Section 34 T11N R1E is the location post.

The above information is shown on the attached map.

DATED AND POSTED on the ground this 25<sup>th</sup> day of August, 2018.

LOCATOR(s)  AGENT

Print Name(s) John Lebamoff

Signature(s) \_\_\_\_\_

ARCH 52232

112° 16' 03.42" W  
34° 16' 00.04" N

BUMBLE BEE QUADRANGLE  
ARIZONA  
TOPOGRAPHIC SERIES

ANC 452232

112° 11' 12.25" W  
34° 15' 00.04" N

Poor Mans Gulch

RECEIVED  
MAZ STATE OFFICE  
2018 SEP - 6 P 3: 10

(CLEATOR)  
Unsurveyed  
Section  
Projections

T11/10N R1E  
Poland Creek  
as provided by

IRMO-P Claim Location Map

HOENIX, ARIZONA

General Land Office  
Master Title Plat &  
Earth Point 2018  
35

Approximate  
Wilderness  
Boundary  
as provided  
by the BLM  
& USFS

33

34

36

Approximate IRMO-P  
Claim Location

Approximate  
Location Post

IRMO-P5

IRMO-P7

IRMO-P8

IRMO-P9

T11N  
TION

3

2

1

9

10

11

12

Public Land Survey System  
subdivision for 20 acres  
is 1320ft x 660ft

034° 15' 12.47" W  
112° 16' 03.42" W

Declination



GN 0.69° W  
MN 10.77° E

(BLACK CANYON CITY)  
SCALE 1:24000

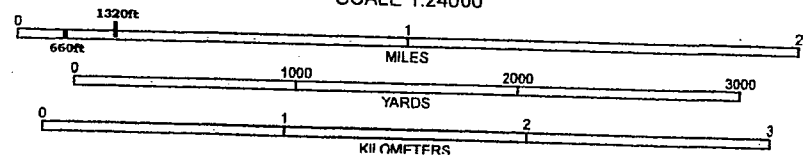

CONTOUR INTERVAL 40 FEET  
NATIONAL GEODETIC VERTICAL DATUM 1929

Copyright (C) 2009 MyTopo

BUMBLE BEE, AZ  
1969

(50)

Navigator  
24,000 Maps  
(AD83)

American 1927 move the projection lines 4M N and 66M



\* See below

LOCATION NOTICE FOR PLACER MINING CLAIM

Amendment BLM Serial # \_\_\_\_\_

NOTICE IS HEREBY GIVEN that the IRMO-P8  
\_\_\_\_\_ placer mining claim has been located by  
USA GOLD MINING, LLC whose current mailing

\* address is 27W438 Knoch Knolls Rd, Naperville, IL 60565

RECEIVED  
BLM AZ STATE OFFICE  
2018 SEP -6 P 3:10  
PHOENIX, ARIZONA  
BLM  
Date  
Stamp

The general course of this claim is East-West and it is situated in Yavapai  
County, Arizona. This claim is 1320 feet in length and 600 feet in width.

20 Total Claim Acreage. This claim runs from the location monument on which this location notice is  
posted at the NE corner of the claim approximately 1320 feet in a West direction to the  
West end line and 0 feet in a East direction to the East end line. This claim is  
marked by four monuments, one at each corner of the claim.

The location monument on which this notice is posted is situated within Section 4, Township  
10N, Range 1E, Gila Salt River Base and Meridian, Arizona. This claim encompasses  
portions of the following legal subdivision(s) if located by legal subdivision or the following quarter section(s),  
section(s), Township(s) and Range(s) SE1/4, NE1/4 of Section 4 T10N R1E  
\_\_\_\_\_, Gila Salt River Base and Meridian, Arizona.

AMC 452233

The locality of this claim with reference to some natural object or permanent monument and additional information  
(if any) concerning its locality are as follows: Approximately 1500 feet south of the NE corner of  
Section 4 is the location post.

The above information is shown on the attached map.

DATED AND POSTED on the ground this 25<sup>th</sup> day of August, 2018.

LOCATOR(s)  AGENT

Print Name(s) John Lebamoff

Signature(s) \_\_\_\_\_

Form MCF102  
Revised July 2014

112° 16' 03.42" W  
034° 13' 00.04" N

BUMBLE BEE QUADRANGLE  
ARIZONA  
TOPOGRAPHIC SERIES

112° 11' 17.25" W  
034° 18' 00.04" N

(CLEATOR)

AMC 452233

Poor Mans Gulch

RECEIVED  
21 MAR 2008  
AZ STATE OFFICE

2008 SEP 6 2 3 10

PHOENIX, ARIZONA

Unsurveyed  
Section  
Projections

T11/10N R1E  
Poland Creek  
as provided by

General Land Office  
Master Title Plat &  
Earth Point 2018

IRMO-P Claim Location Map

Approximate  
Wilderness  
Boundary  
as provided  
by the BLM  
& USFS

Approximate IRMO-P  
Claim Location

Approximate  
Location Post

Public Land Survey System  
subdivision for 20 acres  
is 1320ft x 660ft

(CROWN KING)

(JOES HILL)

(BLACK CANYON CITY)  
SCALE 1:24000

Copyright (C) 2009 MyTopo

Declination

GMM

GN 0.69° W  
MN 10.77° E

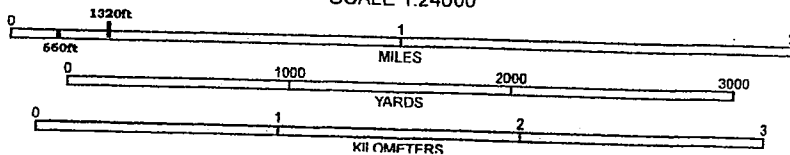

CONTOUR INTERVAL 40 FEET  
NATIONAL GEODETIC VERTICAL DATUM 1929

Navigator  
1:24,000 Maps  
(NAD83)

th American 1927 move the projection lines 4M N and 65M

BUMBLE BEE, AZ  
1969

(5C)

\* See below

**LOCATION NOTICE FOR PLACER MINING CLAIM**

Amendment BLM Serial # \_\_\_\_\_

NOTICE IS HEREBY GIVEN that the IRMO-P9  
\_\_\_\_\_ placer mining claim has been located by  
USA GOLD MINING, LLC whose current mailing  
address is 27W438 Knoch Knolls Rd, Naperville, IL 60565

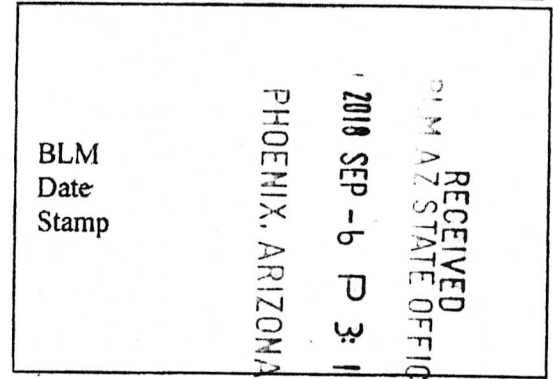

The general course of this claim is East-West and it is situated in Yavapai  
County, Arizona. This claim is 1320 feet in length and 600 feet in width.

20 Total Claim Acreage. This claim runs from the location monument on which this location notice is  
posted at the SW corner of the claim approximately 1320 feet in a East direction to the  
East end line and 0 feet in a West direction to the West end line. This claim is  
marked by four monuments, one at each corner of the claim.

The location monument on which this notice is posted is situated within Section 4, Township  
10N, Range 1E, Gila Salt River Base and Meridian, Arizona. This claim encompasses  
portions of the following legal subdivision(s) if located by legal subdivision or the following quarter section(s),  
section(s), Township(s) and Range(s) SW1/4, NE1/4 and SE1/4, NE1/4 of Section 4 T10N R1E  
\_\_\_\_\_, Gila Salt River Base and Meridian, Arizona.

The locality of this claim with reference to some natural object or permanent monument and additional information  
(if any) concerning its locality are as follows: Approximately 2700 feet south and 1420 feet west  
NE Corner of Section 4 is the location post.

\_\_\_\_\_ The above information is shown on the attached map.

DATED AND POSTED on the ground this 25<sup>th</sup> day of August, 2018.

LOCATOR(s)  AGENT

Print Name(s) John Lebamoff

Signature(s) \_\_\_\_\_

Form MCF102  
Revised July 2014

AMC452234

# IRMO-P Claim Location Map

Unsurveyed  
Section  
Projections  
T11/10N R1E  
Poland Creek  
as provided by

General Land Office  
Master Title Plat &  
Earth Point 2018

Approximate  
Wilderness  
Boundary  
as provided  
by the BLM  
& USFS

Approximate IRMO-P  
Claim Location

Approximate  
Location Post

Public Land Survey System  
subdivision for 20 acres  
is 1320ft x 660ft

2018 SEP - 9 3:10 PM  
BLM AZ STATE OFFICE

RECEIVED

(BLACK CANYON CITY)  
SCALE 1:24000

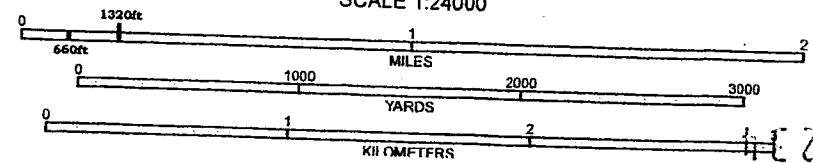

CONTOUR INTERVAL 40 FEET  
NATIONAL GEODETIC VERTICAL DATUM 1988

GN 0 69° W  
MN 10.77° E

Copyright (C) 2009 MyTopo  
Printed Sun Aug 30, 2017

BUMBLE BEE, AZ  
1969

AMC452234

Navigation:  
GS 1:24,000 Maps  
in NAD83

North American 1983 move the projection lines 4M N and 66M

(S)

DEPARTMENT OF THE INTERIOR  
BUREAU OF LAND MANAGEMENT  
Case Recordation

**Geographic Report with Land**

Disposition is equal to **AUTHORIZED , CANCELLED , EXPIRED , PENDING , REJECTED , RELINQUISHED ,  
WITHDRAWN**  
**and** Geo State is equal to **AZ**  
**and** Meridian Township Range Section is equal to **14 0110N 0010E 034**  
**and** Admin State is equal to **AZ**



DEPARTMENT OF THE INTERIOR  
BUREAU OF LAND MANAGEMENT  
Case Recordation  
Geographic Report with Land

Admin State: AZ  
Geo State: AZ

Serial Number	Total Case Acres:	Casetype	Case Disp	Mer	Twp	Rng	Sec	Sur Type	Sur Nr	Suf	Subdivision	Act Pend
AZA 028558	25,517.000	232107	AUTHORIZED	14	0110N	0010E	034	FF			PART S2NESE,S2S2.	

DEPARTMENT OF THE INTERIOR  
BUREAU OF LAND MANAGEMENT  
Case Recordation

**Geographic Report with Land**

Disposition is equal to **AUTHORIZED , CANCELLED , EXPIRED , PENDING , REJECTED , RELINQUISHED ,  
WITHDRAWN**

**and** Geo State is equal to **AZ**

**and** Meridian Township Range Section is equal to **14 0100N 0010E 003**

**and** Admin State is equal to **AZ**

DEPARTMENT OF THE INTERIOR  
BUREAU OF LAND MANAGEMENT  
Case Recordation  
Geographic Report with Land

Admin State: AZ  
Geo State: AZ

Serial Number	Total Case Acres:	Casetype	Case Disp	Mer	Twp	Rng	Sec	Sur Type	Sur Nr	Suf	Subdivision	Act Pend
AZA 028558	25,517.000	232107	AUTHORIZED	14	0100N	0010E	003	ALIQ			NE.S2NW.S2:	
	MNR									E2NENW,		

DEPARTMENT OF THE INTERIOR  
BUREAU OF LAND MANAGEMENT  
Case Recordation

**Geographic Report with Land**

Disposition is equal to **AUTHORIZED , CANCELLED , EXPIRED , PENDING , REJECTED , RELINQUISHED ,  
WITHDRAWN**  
**and** Geo State is equal to **AZ**  
**and** Meridian Township Range Section is equal to **14 0100N 0010E 004**  
**and** Admin State is equal to **AZ**

DEPARTMENT OF THE INTERIOR  
BUREAU OF LAND MANAGEMENT  
Case Recordation  
Geographic Report with Land

Admin State: AZ  
Geo State: AZ

Serial Number	Total Case Acres:	Casetype	Case Disp	Mer	Twp	Rng	Sec	Sur Type	Sur Nr	Suf	Subdivision	Act Pend
AZA 028558	25,517.000	232107	AUTHORIZED	14	0100N	0010E	004	ALIQ			NW,S2	



# UNSURVEYED TOWNSHIP 10 NORTH RANGE 1 EAST OF THE GILA AND SALT RIVER MERIDIAN, ARIZONA

PROTRACTION DIAGRAM NO 16 OFFICIALLY FILED 12/7/1959

YAVAPAI COUNTY  
HASSAYAMPA FIELD OFFICE

STATUS OF PUBLIC DOMAIN  
LAND AND MINERAL TITLES

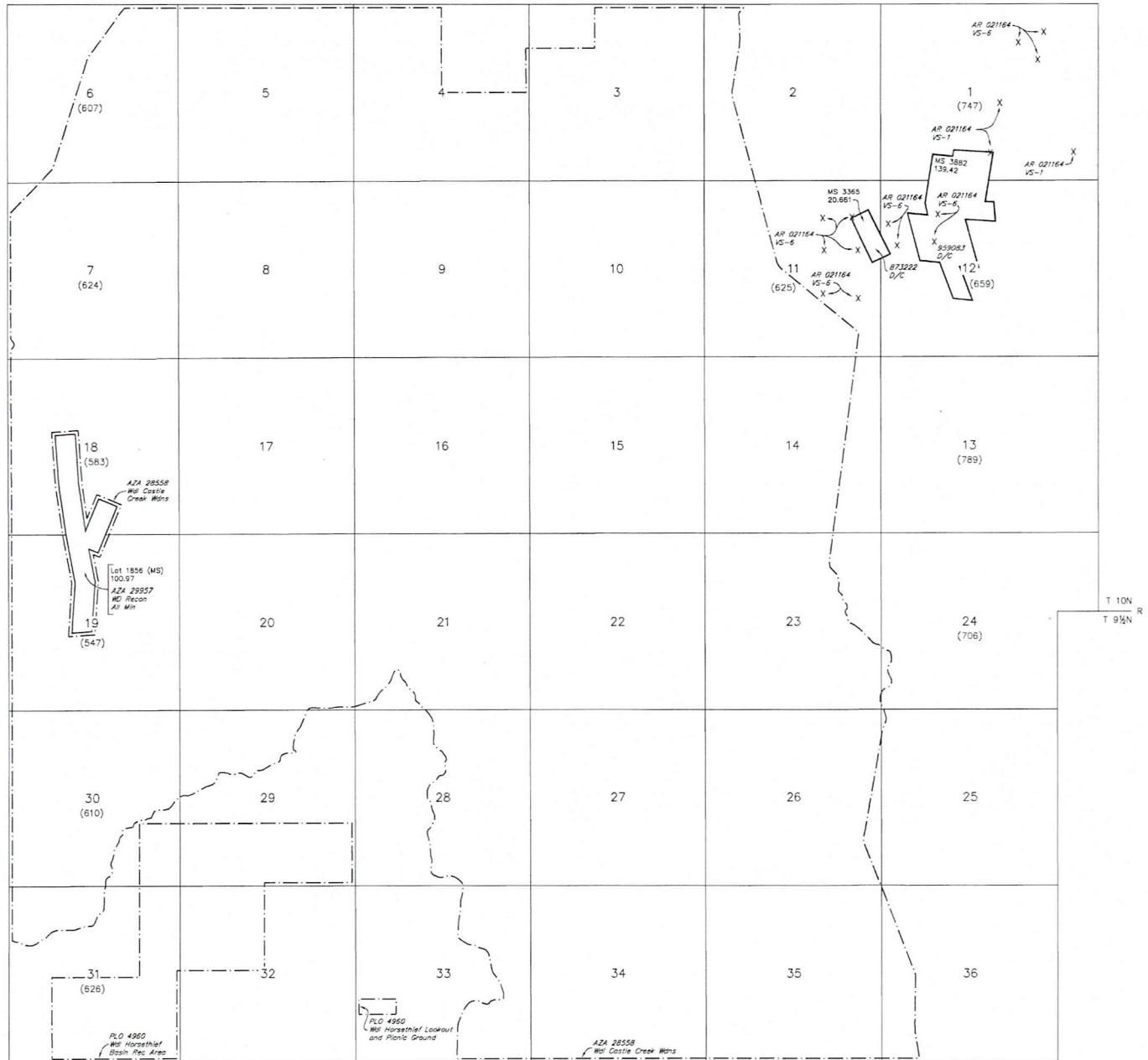

INDEX TO SEGREGATED TRACTS				
RESURVEY TRACT NO	ORIGINAL SURVEY			
	T	R	SEC	SUBDIVISION

*FOR ORDERS AFFECTING DISPOSAL OR USE OF UNIDENTIFIED LANDS WITHDRAWN FOR CLASSIFICATION, MINERALS, WATER AND/OR OTHER PUBLIC PURPOSES, REFER TO INDEX OF MISCELLANEOUS DOCUMENTS.*

- MDS 6 NE
  - 7 NW
  - B SW
- All Tp included in W/ Prescott NF Proc 6 12/21/1899*
- All Tp included in Determination Area PL 167 AR 021164 7/9/1959*

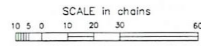

**WARNING STATEMENT**  
This plot is the Bureau's Record of Title, and should be used only as a graphic display of the townships survey data. Records hereon do not reflect title changes which may have been effected by lateral movements of rivers or other bodies of water. Refer to the cadastral surveys for official survey information.

CURRENT TO	DSB	GSR Mer
8-5-2010	ACAD	T 10 N
		R 1 E